

Prineville Lake Acres - Unit 1 - Special Road District (PLA1-SRD)

Minutes for the September 28, 2021

Meeting Location: 7600 SE Walther Loop, Prineville

Mailing Address: PLA1-SRD, 14344 SE Sharps Street, Prineville, OR 97754

Phone: (541) 777-4867 (Cell) / Email: Pvillelakeacres1@gmail.com / Website: www.pla1srd.com

CALL TO ORDER: Treasurer Dan Trump called meeting to order at 6:00 p.m.

BOARD MEMBERS PRESENT:

President: Absent

Secretary: Debbie Kowalski

Treasurer: Dan Trump

Debbie Kowalski had signed up to become an official Board Member. Her official "Oath of Office" was completed on September 27, 2021. A copy of said "Certification of Appointment" is in the Secretary's books. This term of office expires on September 15, 2024.

CITIZENS PRESENT:

1. David Chamberlain
2. Gardner Jeffery
3. Todd Deardorff

MINUTES: Debbie Kowalski presented the August 31, 2021, meeting minutes.

***MOTION:** A motion was made by Dan Trump to approve the August 31, 2021, meeting minutes as submitted. Seconded by Debbie Kowalski. The motion passed by a majority vote: 2-0*

TREASURER REPORT: Dan Trump submitted the August and September Treasurer's Report for review.

Special Road District (Checking Account)

Beginning Balance as of August 1, 2021		\$43,040.30
Income: Property Tax Revenue 8.17.21	\$325.49	\$43,365.79
Income: Brett Bannister - Mailbox	\$100.00	\$43,465.79
Expense: Central Electric Co-op (Light)	\$14.81	\$43,450.98
Expense: Central Or. Weed Control	\$311.09	\$43,139.89
Expense: Prineville Rentals - Hauling trailer	\$2,140.00	\$40,999.89
Expense: Verizon Wireless (Cell phone promo)	\$0.00	\$40,999.89
Expense: Debbie Kowalski (Office Supplies)	\$19.21	\$40,980.68

Prineville Lake Acres - Unit 1 - Special Road District (PLA1-SRD)

Expense: Jared Reid Law (Tax Levy-Election)	\$100.00	\$40,880.68
Expense: Prineville Rental - Excavato	\$4,476.00	\$36,404.68
Ending Balance as of August 31, 2021		\$36,404.68
Less Obligated Debt.	\$3,340.38	\$33,163.62

Special Road District - Remington Road Paving (Savings Account)

Beginning Balance as of August 1, 2021		\$11,844.83
Income: Todd Deardorff - Donation	\$500.00	\$12,344.83
Income: Gardner & Polly Jeffery- Donation	\$500.00	\$12,844.83
Income: Graham Phalen - Donation	\$356.53	\$13,201.36
Ending Balance as of August 31, 2021		\$13,201.46
Pending Interest (.10 cents)		

Beginning Balance as of September 1, 2021		\$36,404.68
Income: Property Tax Revenue	\$57.75	\$36,462.43
Expense: Central Electric Co-op (Light)	\$14.81	\$36,447.62
Expense: Dave Chamberlain - Reimbursement	\$46.12	\$36,401.50
Expense: Verizon Wireless (cell phone)	\$31.25	\$36,370.25
Expense: Jerod Reid Law - Ballot Filing	\$480.00	\$35,890.25
Ending Balance as of September 30, 2021		\$35,890.25

Special Road District - Remington Road Paving (Savings Account)

Beginning Balance as of September 1, 2021		\$13,201.46
Income: Terri & Don New - Donation	\$500.00	\$13,701.46
Income: Michael Smith - Donation	\$200.00	\$13,901.46
Income: Daniel Thompson - Donation	\$1000.00	\$14,901.46
Income: Can / Bottle Drive - Donation	\$963.00	\$15,864.46
Income: Suzi & Cy Flack - Donation	\$100.00	\$15,964.46
Income: Pending Interest	.10 cents	\$15,964.56
Ending Balance as of September 30, 2021		\$15,964.56

***MOTION:** A motion was made by Dan Trump to approve the August and September 2021 Treasurer's Reports as amended. Seconded by Debbie Kowalski. The motion passed by a majority vote: 2-0*

WRITTEN / EMAIL CORRESPONDENCE / PHONE MESSAGES

1. Scott Gabel - Per Dan, Loren Cassidy had contacted this person.
2. Daniel Morrison - Debbie has contacted this person

Prineville Lake Acres - Unit 1 - Special Road District (PLA1-SRD)

OLD BUSINESS

- 1) Update - Roadway Maintenance -
 - a. Remington Road - a huge "Thank You" to Spencer Wilson for operating the excavator and Tony for operating the Grader to smooth out Remington Road.
 - b. Track Skid Steer - There was discussion regarding renting one for maintenance work on Walther Loop.

***MOTION:** Dan Trump made a motion to rent a "Track Skid Steer for 2-weeks, not to exceed \$3000. Seconded by Debbie Kowalski. The motion passed by a majority vote. 2/0 - It was noted the equipment would be delivered the next day.*

- 2) Update - access for filling water into the Water Truck. David Chamberlain said he has not contacted the landowner yet.
- 3) Update: School Bus Sign - Thank you to David Chamberlain and Debbie Kowalski for relocating this sign near the School Bus Stop.
- 4) Update: Newsletter costs: Debbie Kowalski presented the costs for the New
 - a. Crook County Mailing List: \$85.00
 - b. Crook County Labels: \$8.25
 - c. Pack, Ship & More (400 copies of newsletter) \$320.00 (color/2-sided)
 - d. Pack, Ship & More (450 copies of newsletter) \$360.00 (color/2-sided)
 - e. Pack, Ship & More (450 copies of Donation pg. \$
 - f. U.S.P.S - (350 x .49 cents = \$171.50 \$200.00 Estimate
 - g. U.S.P.S - (400 x .49 cents = \$196.00 \$200.00 Estimate
 - h. Envelopes - 1 box of 500 letter size \$10.99
 - i. Donation form - Pack, Ship & More (400 sheets)-\$40.00 (black & white)

***MOTION:** Dan Trump made a motion to start the process for mailing the Newsletters. The cost not to exceed \$750.00. Seconded by Debbie Kowalski. The motion passed by a majority vote. 2/0*

There was discussion on when to send out the newsletters, now or after the Crook County Certification has been completed which is supposed to be about October 12, 2021. This way the Newsletter would have the most current information. It was decided to wait until the Certification has been completed but will start the process so that the Newsletters can be mailed out at least 2 weeks or more prior to the November election.

Prineville Lake Acres - Unit 1 - Special Road District (PLA1-SRD)

- 5) Update – Road Signs: Loren Cassidy was not present to give his updates on Dead End sign on Colt Street and additional Speed Limit signs.
- 6) Update: Finger Harrow – Loren Cassidy was not present to give his update. Todd Deardorff and Debbie Kowalski looked at a “Spring Harrow” at the Hinks but felt it wouldn’t work for our roadways.
- 7) Update: Discussion regarding the Remington Road Paving Project. Due to costs, may have to break up the construction work into two separate projects.
 - a. Received an estimate from SMAF regarding paving amount 1-mile of Remington Road. This estimate was \$326,520.96.
 - b. Requested an updated estimate from High Desert Aggregate & Paving, Inc. regarding paving about 1-mile of Remington Road, on their estimate. This estimate was \$265,995.00.
 - c. Received hourly rates from SMAF for potential snow plowing this winter with their operator and equipment:
 - i. Motor grader: \$170 hourly
 - ii. Skid Steer: \$135 hourly
 - iii. Dump trucks: \$100 hourly
 - iv. Backhoe: \$135 hourly
 - v. Wheel loader: \$175 hourly
 - vi. Labor: \$50 hourly
- 8) Update: Urban Renewal District – Loren Cassidy was not present to give his update, but Debbie Kowalski had contacted the Crook County Court. First, the PLA1-SRD is located within the “Rural” area of the County, not the Urban area. If the County had “Urban Renewal Districts” they would be located within the City Limits. However, Amy at the Crook County Administration Office commented they have no such programs. She had checked with the County Court members, as well as the Crook County Roadmaster.
- 9) Update: Central Oregon Electric Cooperative – There is a wire very loose on the “Light” pole that needs repair. Debbie had contacted them to see about getting it repaired. Debbie had contacted Central Electric Cooperative to see why it has not been repaired yet. They are about 4 weeks out still to repair it. She had reminded them that this wire is close to the School Bus Stop and would hope to have it repaired asap.

Prineville Lake Acres - Unit 1 - Special Road District (PLA1-SRD)

- 10) Update: Grader Operator Training – Dan Trump said he would follow up with his friend to see if he would help with training. It was noted that Todd Deardorff, David Chamberlain, Dan Trump, Nathan Miller and Matt Arian would be interested in training to operate the grader.
- a. Dan Trump to follow-up on checking the fuel level in the tank by the next meeting. It was noted he would get it filled prior to winter, if the grader will be used for blading snow, etc.

***MOTION:** Dan Trump made a motion to fill the diesel fuel tank; not to exceed \$1000. Seconded by Debbie Kowalski. The motion passed by a majority vote. 2/0*
 - b. “Chains” for the grader. Will request Loren Cassidy to follow-up to locate the chains prior to winter snow.
- 11) Update: It was noted that the “Solar Light” at the mailboxes has not been installed yet. Need to make sure it’s installed asap. Loren Cassidy said at the August meeting he would install it. Need to follow up with Loren to see when it will be installed.
- 12) Update: Bus Shelter has been completed. The PLA1-SRD Board needs to send a “Thank You” letter to the Baptist Church. The Church paid and built the Bus Shelter. It was donated to the PLA1-SRD. Possibly make a sign or something to put onto the Bus Shelter. Debbie Kowalski will send a “Thank You” letter to the Church.

NEW BUSINESS:

- 1) Discussion regarding a camera near the mailboxes and community board, plus signs that says “smile, you’re on camera.” Debbie Kowalski will follow up on the signs. No decision was made on a camera at this point.
- 2) Debbie Kowalski indicated she had picked up all the remaining PLA1-SRD boxes of information from Suzi Flack, former Treasurer. The boxes are now stored at Debbie’s residence. She will go through the boxes once she hears back from her Tax Consultant on what information we need to keep and what can be tossed. All minutes must be kept forever. We have Yellow/Orange vests for anyone working along the roadways. The orange construction cones are not any good. Need to order for future roadway hazard areas.

Prineville Lake Acres - Unit 1 - Special Road District (PLA1-SRD)

- 3) Gravel / Blading on roadways (Needs to be scheduled prior to winter - There was discussion on the many roadways that need rock, blading, etc. It was noted that someone needs to do a final road inspection first. David Chamberlain & Debbie Kowalski would inspect all the roadways asap. See attached sheet for inspection results.

There was discussion about the different rock companies. It was felt "Rock Products" had the best rock with fines in it. Dan Trump said that we had \$20,000 still in the "Road Maintenance Line-Item Fund. None of these funds have been used.

A motion was made by Dan Trump to adjourn the meeting at 7:36 p.m. Seconded by Debbie Kowalski. The motion was passed by a majority vote. 2/0

Respectfully submitted,
Debbie Kowalski

Attached:

SMAF Snow Removal Rates

SMAF Remington Road Paving Project Estimate

High Desert Aggregate & Paving, INC. (Estimate update)

October 4, 2021, Road Inspection Report

PLA1-SRD Map

General Application to serve on a Crook County Court Appointed Board

IMPORTANT NOTICE

Loren Cassidy, the current President's term expires on December 31, 2021. If you are interested in joining the board, but have questions, please contact a PLA1-SRD Board Member for more information, or you can contact the Crook County Administrative Office across the street from the Courthouse Building. An application for "appointment" is attached for your convenience. Submit your application to the Crook County Administration's Office ASAP, or prior to December 1st, 2021 or before, so that the Crook County Court can get your appointment request on their agenda to appoint you to the position before the end of the year.

The PLA1-SRD Board hopes you give it some thought. You will learn what it takes to keep our roadways maintained. Looking for someone that has a vision to improve our roadways.

**GENERAL APPLICATION TO SERVE ON A CROOK COUNTY
COURT-APPOINTED BOARD OR COMMITTEE**

Position applied for: _____

Name: _____

Address: _____

Phone Number: _____

Email: _____

Please list any relevant experience you may have that would make you effective in the position:

Why do you wish to serve in this position?

A letter of interest maybe submitted in lieu of this form.

SMAF CONSTRUCTION

PO Box 672, Prineville, OR 97754
 P 541.447.5643
 FAX 541.447.2190
 EMAIL: christyd@whhsmaf.com

2020/2021
**SNOW REMOVAL
 CONTRACT**

Thank you for considering SMAF Construction as your snow removal service for the upcoming 2020-2021 winter season. This year we are again offering a NO call, NO hassle snow removal service. It is our intention to bring you our high quality service throughout the snow season by having you fill out the information below and sending it back to us via mail, email, or fax. We will take it from there.

QUESTIONS??? Give us a call.

Please fill in all blanks

COMPANY NAME: _____

BILLING ADDRESS: _____

CONTACT NAME: _____

PHONE: _____

EMAIL: _____

NAME OF BUSINESS/LOCATION OF SITE: _____

Complete removal by: _____ am/pm

Depth of snow to start removal:
 1" 2" 3" (circle one)

Sidewalks cleared: YES NO

Ice Melt on sidewalks: YES NO

Special conditions or other requests:

Please list specific areas of concern to be aware of (i.e. propane tanks, fuel tanks, above ground utilities, curbs, etc.)

		<u>RATES</u>	
Motor grader	¹⁷⁰ \$155.00/hour	Backhoe	¹³⁵ \$125.00/hour
Skid steer	¹⁷⁵ \$125.00/hour	Wheel loader/4 yd	¹⁷⁵ \$160.00/hour
Dump trucks	¹⁰⁰ \$ 95.00/hour	Labor	\$ 47.00/hour
Ice Melt	\$ 50/lb		⁵⁰

SIGNATURE _____ DATE _____

"Estimate"

SMAF CONSTRUCTION

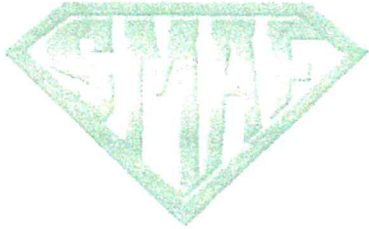

SMAF CONSTRUCTION, LLC
P.O. BOX 672
2260 INDUSTRIAL PARK WAY
O) 541-447-3643
F) 541-447-2190
CCB = 159128

Received
9/28/21

9/28/2021
Debbie Kowalski -- PLA 1
15127 SE Springfield Street
Prineville, OR 97754
541.903.0721
ddgorski1905@gmail.com

BUDGET ONLY

RE: Paving approx 1 mile of road with shoulders, grind option

DESCRIPTION	QUANTITY	UNIT	UNIT PRICE	EXTENSION			
100 - MOBILIZATION/LOCATES						\$	2,082.17
MOBILIZATION - LOCAL	16.00	HRS	\$ 130.00	\$	2,082.17		
PRIVATE LOCATES	0.00	HRS	\$ 130.00	\$	-		
200 - NEW CULVERT ACROSS REMINGTON						\$	4,655.95
120/135 EXCAVATOR	6.00	HRS	\$ 175.00	\$	1,050.00		
SKID STEER	6.00	HRS	\$ 135.00	\$	810.00		
DUMP TRUCKS	0.00	HRS	\$ 100.00	\$	-		
LABOR	12.00	HRS	\$ 50.00	\$	600.00		
LASER/TRANSIT	1.00	DAYS	\$ 75.00	\$	75.00		
3/4" - 0 ROCK DEL	50.00	YD	\$ 24.42	\$	1,220.95		
FLAGGER	18.00	HRS	\$ 50.00	\$	900.00		
300 - DEMO AND BLADE REMINGTON AND SECTIONS TO BE PAVED						\$	12,190.00
672 BLADE	24.00	HRS	\$ 170.00	\$	4,080.00		
GRADE TRACTOR	12.00	HRS	\$ 135.00	\$	1,620.00		
84 in ROLLER	20.00	HRS	\$ 155.00	\$	3,100.00		
WATER TRUCK	24.00	HRS	\$ 110.00	\$	2,640.00		
LABOR	8.00	HRS	\$ 50.00	\$	400.00		
LASER/TRANSIT	4.00	DAYS	\$ 75.00	\$	300.00		
PLATE COMPACTOR	1.00	DAYS	\$ 50.00	\$	50.00		
3/4" - 0 ROCK DEL	0.00	YD	\$ 24.42	\$	-		

** FLAGGING NOT INCLUDED, MAY NOT BE NEEDED

400 - PREP AND ROCK FOR PAVING W/ASPHALT		6" OF ROCK		\$	281,576.30
672 BLADE	36.00 HRS	\$ 170.00	\$ 6,120.00		
GRADE TRACTOR	16.00 HRS	\$ 135.00	\$ 2,160.00		
84 in ROLLER	30.00 HRS	\$ 155.00	\$ 4,650.00		
WATER TRUCK	40.00 HRS	\$ 110.00	\$ 4,400.00		
LABOR	36.00 HRS	\$ 50.00	\$ 1,800.00		
LASER/TRANSIT	5.00 DAYS	\$ 75.00	\$ 375.00		
PLATE COMPACTOR	1.00 DAYS	\$ 50.00	\$ 50.00		
3/4" - 0 ROCK DEL	2714.44 YD	\$ 24.42	\$ 66,284.02		
PULVERIZATION OF REMINGTON	1.00 LS	\$ 16,100.00	\$ 16,100.00		
ASPHALT	12063.00 SY	\$ 14.56	\$ 175,637.28		
FLAGGER	80.00 HRS	\$ 50.00	\$ 4,000.00		
500 - SHOULDER ASPHALT - 1' - 2' ON EACH SIDE				\$	26,016.54
672 BLADE	12.00 HRS	\$ 170.00	\$ 2,040.00		
GRADE TRACTOR	12.00 HRS	\$ 135.00	\$ 1,620.00		
47 in ROLLER	12.00 HRS	\$ 135.00	\$ 1,620.00		
WATER TRUCK	12.00 HRS	\$ 110.00	\$ 1,320.00		
LABOR	24.00 HRS	\$ 50.00	\$ 1,200.00		
PLATE COMPACTOR	2.00 DAYS	\$ 50.00	\$ 100.00		
3/4" - 0 ROCK DEL	660.00 YD	\$ 24.42	\$ 16,116.54		
FLAGGER	40.00 HRS	\$ 50.00	\$ 2,000.00		
TOTAL				\$	326,520.96

** I'M SURE THE COUNTY WILL HAVE A SAY IN ROAD CONSTRUCTION, THEY MAY HAVE SOME OTHER REQUIREMENTS
 ** BUDGET ONLY

If you have any questions please give me a call at 541-447-5643 or on my mobile phone at 541-480-7974.
 Thank you,

Mel Davis

Estimate

HIGH DESERT AGGREGATE & PAVING, INC ASPHALT PAVING & CONSTRUCTION PROPOSAL

CUSTOMER: DEBBIE KOWALSKI / PLA 1

 PHONE: 541-833-0371
 FAX: _____

DATE: 20-Sep-21
 QUOTE # P21-442
 BY: STEVEN BURNS

PROJECT: REMINGTON RD. PRINEVILLE
 CONTACT: _____

BID DATE: _____

We propose to furnish labor, materials and equipment to fully complete the work as specified.

ITEM NO.	DESCRIPTION	EST. QUANTITY	UNITS	UNIT PRICE	EST. TOTAL PRICE
1	FURNISH AND PLACE 2" OF 3/4" AGGREGATE BASE OVER APPROX. 111295 SF. PULVERIZE EXISTING. BASE MATERIAL TO A DEPTH OF 6" AND COMPACT. CONCRETE AND COMPACT.	1	LS	\$54,200.00	\$54,200.00
2	PAVE APPROX. 103357 SF WITH 4" ASPHALT	1	LS	\$197,755.00	\$197,755.00
3	FURNISH AND PLACE SHOULDER ROCK.	1	LS	\$14,000.00	\$14,000.00

INCLUSIONS/EXCLUSIONS/COMMENTS:

Due to volatile petroleum markets, this quote is subject to price changes and the availability of materials at the time of construction.

Sub grade by others. 1.5% minimum slope required for adequate drainage.

Price does not include utility adjustments, permits and flaggers.

Payment to be made as follows: UPON COMPLETION.
 Ret. due accounts are subject to 1.5% per month finance charge. Quotes are valid for acceptance within 30 days.

All materials are guaranteed to be as specified. All work to be completed in a workmanlike manner according to standard practices. Any deviation from the specifications involving extra costs will be executed only upon written orders and will become an extra charge over and above the estimate. Materials and workmanship are warranted for one year.

Acceptance of Proposal: The above prices, specifications and conditions are satisfactory and are hereby accepted. You are authorized to do the work as specified. Payment will be made as outlined above.

 Date of Acceptance

 Signature

Prineville Lake Acres – Unit 1 – Special Road District

ROAD INSPECTION REPORT

October 4, 2021

Meeting Location: 7600 SE Walther Loop, Prineville

Mailing Address: PLA1-SRD, 14344 SE Sharps Street, Prineville, OR 97754

Phone: (541) 777-4867 (Cell) / **Email:** Pvillelakeacres1@gmail.com / **Website:** www.pla1srd.com

(Road Inspection completed by Debbie Kowalski & David Chamberlain)

PRIORITY PROJECTS #1:

The following roadways are priority projects because they are the “main” roadways that connect to all the secondary roads.

REMINGTON ROAD: (Priority Project) – Starting from Davis Loop towards the Ruger Road/Remington Road intersection, will fill the potholes as best as possible near the Community Board /mailbox area. This portion of the roadway will need additional maintenance throughout the winter season.

REMINGTON ROAD: (Priority Project) – Starting from the Remington Road/Ruger Road intersection, going South, towards the top of the hill. Most of this portion of Remington is down to bed rock. Needs rock and blading all the way to Winchester Loop/Remington Road intersection.

RUGER ROAD: (Priority Project) – Starting from the intersection of Remington Road & Ruger Road, going east towards Gatling Way/Derringer Loop intersection, large portions of this roadway are down to the bedrock. Need rock and blading. Culverts just before the intersection needs at least 4” of rock to protect the culvert.

- a. Need extra rock on top of culvert to protect from future damage (4” rock over culvert area)

RUGER ROAD / GATLING WAY / DERRINGER LOOP INTERSECTION: (Priority Project) - Starting at the culvert on Gatling, add rock & blading within the intersection area, continue around the corner towards Ruger Road. There is an **exposed** culvert within this area that needs at least 4 inches of rock to protect the culvert. The roadway within this area is down to bedrock.

- a. Exposed Culvert needs additional rock to protect culvert from future damage.

GATLING WAY: (Priority Project) - Starting from Purdy Place, headed NW, all the way to Walther Loop, Derringer Loop & Ruger Road intersection, this area is down to bedrock and needs rock and blading. There were several culverts that need cleaned out so that the water runoff will drain better: 7687, 7669 and 7651 SE Gatling Way. 7635 SE Gatling Way has no culvert for water drainage.

A. FUTURE PROJECT:

- a. Several culverts need to be cleaned out and/or driveways need a culvert.
- b. Ditching may be required to water runoff to drain properly, and not on the roadway.

WINCHESTER LOOP: (Priority Project) - Starting from the intersection of Winchester Loop & Walther Loop down towards Ruger Road, need to blade (move rock from the sides/shoulders of this road first. There are large portions of the roadway that are down to the bedrock; about .3 mile. Need rock and blading. At the intersection of Winchester Loop and Ruger Road, need additional rock & blading. Ditching required on the uphill sides of the roadway. Culverts may be needed.

A. FUTURE PROJECT:

- a. Ditching on the uphill sides of the roadway
- b. Culverts may be needed once ditching has been completed.

PRIORITY PROJECTS #2:

These projects are roadways that are down to dirt and need rock within a portion of the roadway. It looks as if these roadways have not been maintained in quite some time.

THOMPSON COURT: Needs rock and blading, especially at the end of road. The end of the roadway is down to dirt. Needs rock at the intersection of Thompson Court and Walther Loop. Blade rock from shoulders back onto the roadway.

- a. Portions of this roadway are down to dirt only.

BENELLI LANE: At the end of this road, before the steep hill, rock is needed. Down to dirt. 1648 SE Benelli Lane needs a culvert. Need ditching on the uphill side of this roadway. Blade roadway, add rock if needed.

A. FUTURE PROJECT:

- a. Ditching on the uphill side(s) of the roadway for proper rain runoff to drain.
- b. Portion at the end of this roadway down to dirt only.

PRIORITY PROJECTS #3:

The following roads have steep hills:

WALTHER LOOP: Starting at the NE corner, headed south, starting at the bottom of the dip, north side of culvert, at approximately 7512 SE Walther, needs rock bladed and rolled all the way to Sharps Street. Once at the top of the hill, going south, no rock needed at this time. Starting at the Walther Loop / Sharps intersection, no rock needed to almost the Walther Loop/Gatling Way Intersection. This intersection needs blading and rock.

SHARPS STREET: Starting from Walther Loop going down Sharps Street, just before 14497 SE Sharps needs 1.5" rock and blading all the way to Walther Loop.

BERRETTA WAY: The biggest portion of this roadway is down to bedrock. On top, going over the hill towards the Cul-de-sac area, needs some rock hammering. Needs rock and blading.

A. FUTURE PROJECT:

- a. Rock Hammering (difficult area to ditch, due to solid rock, just over the top of the hill)

GLOCK STREET: Needs rock at the intersection of Remington Road & Glock Street, continue up the hill with rock to 6355 SE Glock. In addition, from the intersection of Glock Street & Webley Way, going west towards Springfield Street, need rock and blading. Portion just before the corner to Springfield is down to bedrock. There is a big rock in the roadway that needs to be hammered out. Ditching on the uphill sides of the roadway.

A. FUTURE PROJECT:

- a. Rock Hammering
- b. Ditching on the uphill side(s) of the roadway for proper rainwater runoff to drain in a ditch, not the roadway

DERRINGER LOOP: Starting from the intersection of Derringer Loop, Ruger Road & Gatling way, need to first blade rock on the shoulders back onto the roadway. Once bladed, add rock after first corner. Down to dirt on portions of roadway. Ditching and culverts are needed on the uphill side of the roadway; this will keep the rain flowing on the sides of the roadway, not on the roadway. Some residences need the "Green Fire Marker Signs."

A. FUTURE PROJECT:

- a. Ditching on the uphill side of roadway
- b. Culverts are needed at several driveways.

- c. Several residences need 911 green fire marker signs.

PRIORITY PROJECTS #4:

WALTHER LOOP: Starting from the intersection of Walther & Sharps headed east, up the hill, no gravel until road work has been completed. From this intersection, headed west, no rock needed at this time. However, there were a few residences with no “Green Fire Marker” signs at their driveway.

A. FUTURE PROJECT:

- a. 911 Green Fire Marker Signs needed

SPRINGFIELD STREET: Needs the rock on the shoulders bladed back onto the roadway all the way up the hill. There are driveways on the uphill sides of the road that need culverts installed. Ditching needed on the uphill side of roadway. Some of the culverts need to be repaired or a new culvert installed that works. One was severely damaged; needs to be replaced to keep the water flowing on the side the road in lieu of running down the roadway. Hammering a big rock in front of 15127 SE Springfield Street’s driveway.

A. FUTURE PROJECT:

- a. Rock Hammering in front of driveway at 15127 SE Springfield Street
- b. Ditching on the uphill sides of the roadway
- c. Culverts need to be installed and/or repaired and/or replaced.

WALTHER LOOP: Starting from the intersection of Walther Loop and Gatling Way, NE end, requires ditching on the uphill side. 7833 requires a new culvert. Needs rock and blading from this intersection, around the SE corner, all the way to Purdy Place.

A. FUTURE PROJECT:

- a. Ditching needed on the uphill sides of the roadway.
- b. Culverts may need to be repaired and/or replaced.

PURDY PLACE: This road is in good condition. Need to blade roadway, no rock needed. 15036 SE Purdy, the culvert pipe needs repair. At the intersection of Purdy Place and Gatling Way needs additional rock & blading.

A. FUTURE PROJECT:

- a. Culvert(s) may need repair and/or replaced

WALTHER LOOP: Starting from the intersection of Walther Loop & Purdy Place, headed towards Winchester Loop needs rock. This area is down to bedrock. Rock and blading needed.

STEN COURT: At the intersection of Sten Court and Walther Loop, the culvert needs to be checked to see if it needs to be replaced. Blade rock on the shoulders back into the roadway.

A. FUTURE PROJECT

- a. Culvert that crossed over the roadway, at the intersection, needs to be checked to see if it's needs cleaning out or if it needs to be replaced.

BROWNING STREET: At the end of this roadway in down to bedrock. The remainder of this roadway can be bladed. Bring rock along the shoulders back onto the roadway. This roadway needs trees removed within the right-of-way, needs ditching on uphill sides of the roadway. The south side ditch appears to be okay, but the north side needs ditching. Culverts will be needed once ditching has been completed. 911 green fire marker signs needed. At some point, will need a culvert to cross over from the north ditch to the south side ditch for rain runoff to flow properly.

LEE WAY: This roadway is in good condition. Blade the existing rock from the shoulders back onto the roadway.

COLT STREET: The "Colt Street" sign is missing. Need to order sign. In addition, this also needs a "Dead End" sign. There is no access to BLM from this street. The roadway needs rock and blading.

A. FUTURE PROJECT

- a. Order "Colt Street" and "Dead End" signs
- b. The "Colt /Mossberg Sign has been located. Need a work party to attach the sign back to the existing post or purchase a new 4x6 wooden pole.

STEVENS STREET: Blade roadway, add rock where needed. Will need rock at the NE end of this roadway. Additional rock & blading in the intersection of Stevens Street & Webley Way. Ditching on the uphill side of roadway.

A. FUTURE PROJECT

- a. Ditching on the uphill side of the roadway.

MAGNUM COURT: Blade rock first from the shoulders. Add rock as needed.

WEBLEY WAY: At the intersection of Webley Way / Glock Street, the culvert needs to be checked to see if it needs cleaning. Ditching needs to be done on the uphill side of the roadway so the rain runoff stays within a ditch, not on the roadway. From the intersection of Webley Way / Stephens Street, going up the hill, this really needs rock

hammering just past 15247 SE Webley Way. Two culverts are exposed at 15247 SE Webley Way that require additional rock to protect the culverts. Needs ditching on the uphill side of the roadway. From the top of the hill, going towards Remington Road, needs 2" rock on roadway and bladed all the way to Remington Road.

A. FUTURE PROJECT

- a. Hammering rock
- b. Ditching on the uphill sides of the roadway

MOSSBERG LOOP: Need to blade existing rock on shoulders back onto the roadway, add rock where needed after blading. From the intersection of Mossberg Loop / Stevens Street to the top of the steep hill, blade only to the intersection of Colt Street & Mossberg Loop. Once around the corner to the right, continue with blading only to Springfield Street. Signs missing at the intersection of Colt Street/Mossberg Loop.

A. FUTURE PROJECT

- a. Ditching on both sides of the roadway so the water runoff stays on the sides of the roadway, not on the roadway.
- b. Culverts may be needed.
- c. The Mossberg / Colt Street sign has been located. Need a work party to get it hung up to the existing post.

WEATHERBY LOOP: Blade roadway first. Rock Hammering just before the corner and around the corner. Add rock as needed once bladed.

A. FUTURE PROJECT

- a. Rock Hammering
- b. Ditching on the uphill sides of roadway
- c. Culverts may be needed.

WINCHSTER LOOP: Starting from the intersection of Weatherby Loop & Winchester Loop, going towards Remington Road, needs rock and blading. The portion going down the hill towards the intersection of Winchester Loop and Walther Loop, needs rock hammering. Do not add any rock.

A. FUTURE PROJECT

- a. Rock Hammering
- b. Ditching on the uphill sides of roadway
- c. Culverts may be needed

PARKER PLACE: The “Parker Street” sign is missing. Need to order sign. In addition, this also needs a “Dead End” sign.

A. FUTURE PROJECT

- a. Need to order “Parker Street” and “Dead End” signs.

ATTENTION PROPERTY OWNERS

As everyone knows, the PLA1-SRD has very limited funds for maintenance. Our funds are regulated by the Special Districts of Oregon and are based on improvement assessments on each property owners lots. The assessments are completed by the Crook County Assessor’s Office.

The road work projects will be prioritized. The main roadways will be maintained first. Other roadways will be done as funds allow. Some roadways may not get any improvements due to lack of funds for maintenance. The Board will do their best to get help on the most needed areas. At the same time, funds need to be reserved in case of snow removal this winter and/or potential flooding in the springtime.

Future projects will be prioritized for future work. Volunteers are needed to work on these projects. Property Owners will be contacted prior to their roadway being worked on. We are asking the property owners along each of the project roads to help volunteer with the needed improvements. Can you help with some of our projects? Please remember, the Board members are Volunteers as well!

GRADER OPERATOR TRAINING - NEED VOLUNTEERS

We need property owners that would like OR are willing to learn how to operate the “Grader” to help blade rock on our roadway and/or potentially help plow snow this winter. The PLA1-SRD owns a grader, but we need “TRAINED” volunteers. If you are interested in learning how to operate, please contact the PLA1-SRD by calling (541) 777-4867 immediately. By using our own grader, the PLA1-SRD would save \$\$\$\$\$\$ for road maintenance.

This is the section of the PLA1-SRD 2021-22 Budget for Road Maintenance.

		MATERIAL AND SERVICES			
\$1,500.00	\$220.00	Office Supplies //news letter/etc.			\$1,500.00
		Board Member			
\$1,000.00	\$0.00	Confrence/Training/lodging/food/gas			\$0.00
\$200.00	\$100.00	Gift Certificates			\$2,000.00
\$180.00	\$178.00	Utilities (Mail Box Light)			\$185.00
\$100.00	\$0.00	PLA1-SRD annual Road Clean-up / Bar-B-Q/dump fee			\$250.00
\$7,000.00	\$0.00	Easement Maintenance: weed control, tree removal			\$7,000.00
\$2,000.00	\$0.00	Grader & Water Truck Maintenance: fuel, etc.			\$2,000.00
\$5,000.00	\$546.00	Grader / Water Truck: tires & special parts			\$5,000.00
\$17,844.00	\$6,343.00	Road Surface Materials/Hired Contractors			\$20,000.00
\$12,000.00	\$0.00	*Reserve for Paving Project*			30,854.00
\$46,824.00	\$7,387.00	TOTAL MATERIAL & SERVICES			\$68,789.00

If you should want to see the complete 2021/22 Budget, go to www.pla1srd.com

ROAD MAINTENANCE COSTS / QUOTES

PILOT BUTTE ROCK PRODUCTS

Clint Woodward (Owner) quoted prices are by the ton, delivered to PLA1-SRD.

Dump Truck: \$19.50 per ton x 15 tons per load (3/4" rock w/fines) = \$292.50 per load estimate.

Dump Truck: \$17.50 per ton x 15 tons per load (1 1/2" rock w/fines) = \$262.00 per load estimate.

Belly Dump: \$17.00 per ton x 25 tons per load (3/4" rock w/fines) = \$425 per load estimate fee

Belly Dump: \$15.00 per ton x 25 tons per load (1 1/2" rock w/fines) = \$225.00 per load estimate.

Grader w/operator: \$175.00 per hour (8-hour day x \$175 = \$1400)

Vibrator Roller w/operator: \$150 per hour (\$150 x 8-hour day = \$1200)

Water Truck w/operator: \$130 per hour (\$130 x 8-hour day = \$1040)

BARTLETT EXCAVATION & CONSTRUCTION, LLC

Jake Adkins (Owner) quoted prices per ton, per load, delivered to PLA1

Dump Truck: \$312.50 per load (1 ½" minus rock w/ fines (approximate 15 tons) per load estimate)

Grader Equipment w/operator: \$130 per hour (\$130 x 8 hours = \$1040 per day)

Roller Equipment w/operator: \$95 per hour (\$95 x 8 hours = \$760 per day)

Water Truck w/operator: \$145 per hour (\$145 x 8 hours = \$1160 per day)

SMAF CONSTRUCTION, LLC

Mel Davis (Project Estimator/Manager) quoted prices per yard

Dump Truck: \$24.42 per yard (¾" rock. Dump Truck load holds about 10 yards - \$244.20 per truck load, estimate) - **PLUS \$235 each way mobilization fee!!** Belly Dump say cost, \$24.42 per yard.

Grader Equipment w/operator: \$170 per hour (\$170 x 8 hours = \$1360 per day)

Roller Equipment w/operator: \$155 per hour (\$155 x 8 hours = \$1240 per day) - **PLUS \$206 each way mobilization fee!!**

Water Truck w/operator: \$110 per hour (\$110 x 8 hours = \$880 per day)

TREE REMOVAL WITHIN THE 60-FOOT ROAD RIGHT-OF-WAY & SPRAYING OF WEEDS

It would be most helpful if each property owner can remove all trees within the 60-foot right of way in front of your property. If your property is located on a corner, please remove **ALL** trees along both streets. This helps by allowing the sunshine to get onto the roadways to melt the "snow" in the winter, plus it helps with "Sight" distance at intersections for on-coming traffic. If you need help, please let a board member know. When cleaning up the right of way area, spray the weeds within the same right-of-way area. If the property owner can keep their own weeds down, this will save money for well needed roadwork projects and maintenance, instead of spraying for weeds!!!!

911 GREEN FIRE MARKER SIGNS

The 911 Green Fire Marker Signs are very important to have installed at or as close as possible to your driveway, especially when you or a family member have a medical emergency. When every second counts, whether it's daytime or night-time, you want emergency services to "FIND" your residence. If they can't find your driveway, it could be a matter of a life-or-death situation. The Fire Marker signs cost **\$25.00 per sign**. They are green signs w reflective lettering on both sides. This makes it very easy for emergency services to find your residence, especially at night-time. To order a 911 Green Fire Marker Sign, call Crook County Community Development Department. This Department is located within the Crook County Courthouse Building. You will receive the reflective 911 green sign, stake, and attachments for the sign. Their phone number is **541-447-3211**

.....

SNOW REMOVAL COSTS

Please remember, when blading snow in the winter, there is over 12 miles of roadway that need to be cleared. It may take a day or two to clear all the roads, depending on the amount of snow being removed. Once there is about 5-7 inches of snow on the ground, the roads would be bladed. Property owners/renter is responsible for blading your own driveways, not the Special Road District.

SMAF Construction LLC
Mel Davis (Project Estimator/Manager)

Motor Grader: \$175 per hour

Backhoe: \$145 per hour to clear the snow at the entrance to driveways
(No mobilization fee because their equipment is already up Juniper Canyon doing snow blading work for Crook County. They clear roadways on County Maintained Roads within several subdivisions)

PILOT BUTTE ROCK PRODUCTS
Clint Woodward (Owner)

Clint is busy with Les Schwab Tires properties, and doesn't have time for snow plowing.

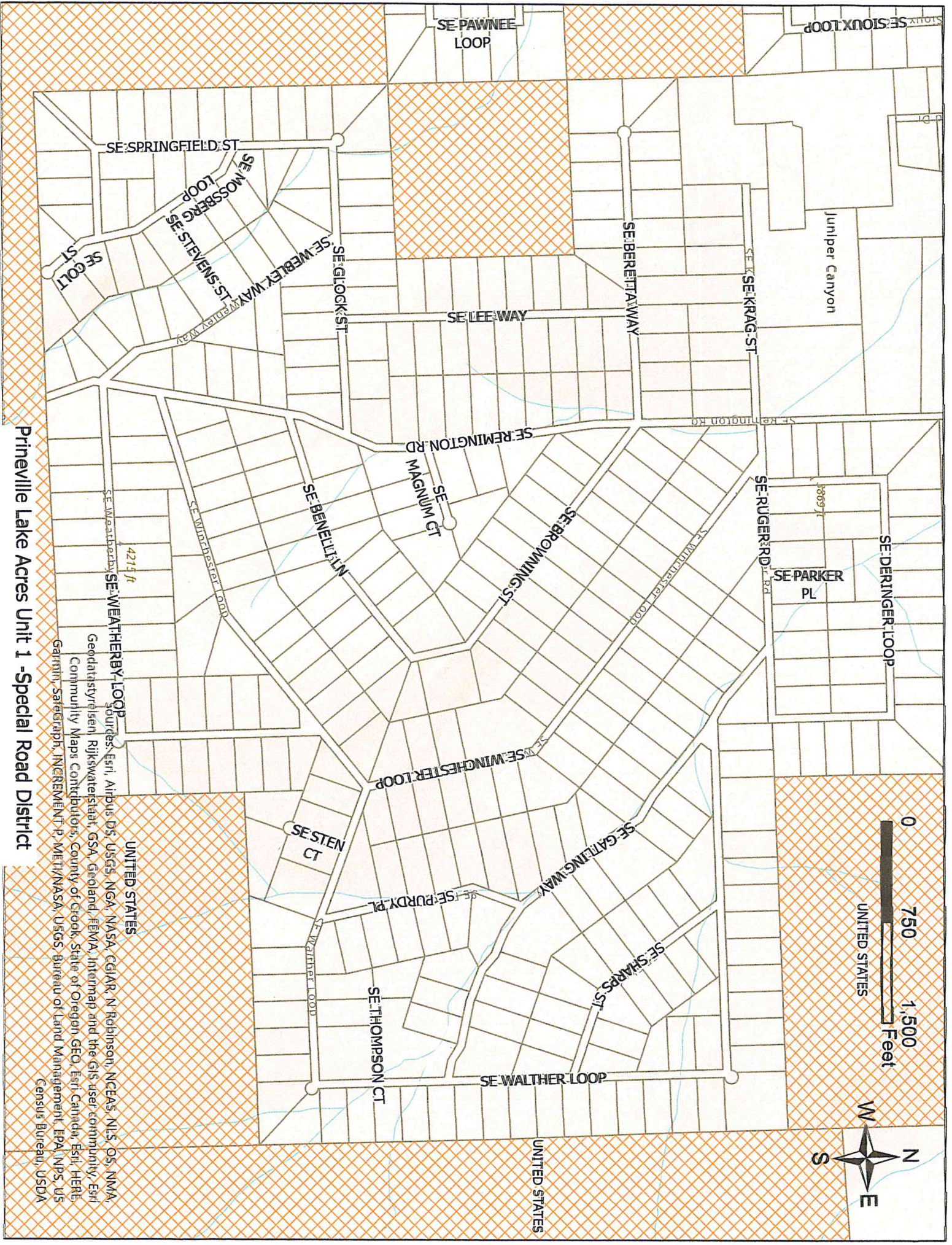

Prineville Lake Acres Unit 1 - Special Road District

UNITED STATES

Sources: Esri, Airbus DS, USGS, NGA, NASA, CGIAR, N. Robinson, NCEAS, NLS, OS, NIMA, Geodatasystemen, Rijkswaterstaat, GSA, GeoLand, FEMA, Intermap and the GIS user community, Esri Community Maps Contributors, County of Crook, State of Oregon GEO, Esri, Canada, Esri, HERE, Garmin, Swire, INCREMENT P, METI/NASA, USGS, Bureau of Land Management, EPA, INPS, US Census Bureau, USDA

4215 ft

